



WIPERS (SINGLE-ACTING)

Wiper AS

Wiper with metal housing and protruding wiper lip. Used in various applications, including for installation spaces as per ISO 6195 Type B.

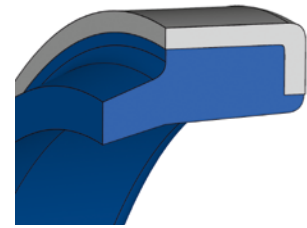

MATERIAL	88 NBR 101	88 NBR 99035
 MAX.	-30 to +100 °C	-30 to +100 °C
 MAX.	2 m/s	2 m/s
	Primarily for spare parts requirements. For new designs, we recommend more modern series, such as the AU AS(R)	



AS

Wiper ASOB

Wiper with protruding wiper lip but no metal reinforcement.

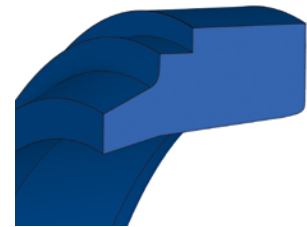

MATERIAL	88 NBR 101
 MAX.	-30 to +100 °C
 MAX.	2 m/s
	Primarily for spare parts requirements. For new designs, we recommend more modern series, such as the PU5



ASOB

Wiper AU PS

Wiper with metal housing and a wiper lip that sits flush with the housing. Used in various applications, including for standardized installation spaces as per ISO 6195 Type B.

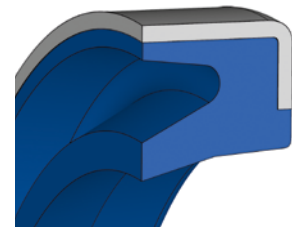

MATERIAL	94 AU 925
 MAX.	-30 to +110 °C
 MAX.	2 m/s
	Earth-moving equipment, forklift trucks, tail lifts, agricultural machines, truck cranes, swivel pin sealing, support cylinders



AU PS

Wiper AU AS, AU ASR

Wiper with metal housing. The protruding wiper lip has a sharply defined sealing edge. Used in various applications, including for installation spaces as per ISO 6195 Type B.

MATERIAL	94 AU 925
MAX. 	-30 to +110 °C
MAX. 	2 m/s
	Earth-moving equipment, forklift trucks, tail lifts, agricultural machines, truck cranes, presses, support cylinders

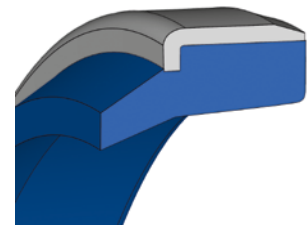

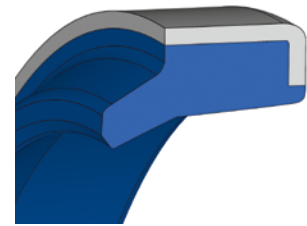

AU AS



AU ASR

Wiper AU ASOB

Wiper without metal reinforcement but with protruding wiper lip and base support to prevent twisting. For standardized installation spaces as per ISO 6195 Type A.

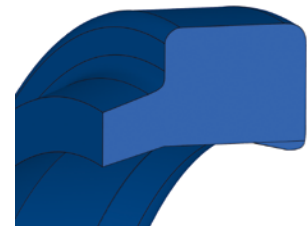

MATERIAL	94 AU 925
MAX. 	-30 to +110 °C
MAX. 	2 m/s
	Primarily for spare parts requirements. For new designs, we recommend more modern series, such as the PU5



AU ASOB

Merkel wiper P6

Wiper with protruding wiper lip and support segments to prevent twisting.

MATERIAL	85 NBR B247	85 FKM K664
MAX. 	-30 to +100 °C	-10 to +200 °C
MAX. 	2 m/s	2 m/s
	Industrial presses, hydraulic steelwork, rolling mills	

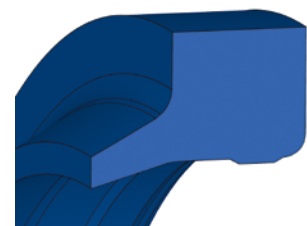



P6

Seals for fluid power applications

Wiper PU5

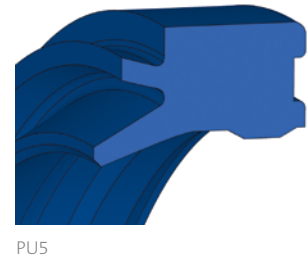

Wiper with additional static sealing lip and support elements to prevent twisting. Used in various applications, including for installation spaces as per ISO 6195 Type A.

MATERIAL	95 AU V149
MAX. 	-30 to +110 °C
MAX. 	2 m/s
	Mining, earth-moving equipment, forklift trucks, tail lifts, agricultural machines, truck cranes, industrial presses, injection molding machines, support cylinders, telescopic cylinders



Merkel wiper PU6, PH6

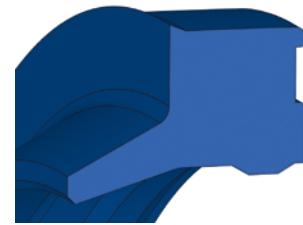
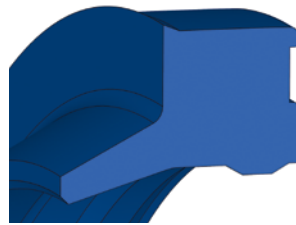
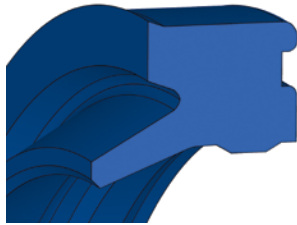

Wiper with static sealing edge on the external perimeter and with support elements to prevent twisting.

MATERIAL	95 AU V142, 95 AU V149, 97 TPE TP106, 97 TPE TP107	93 AU V167
MAX. 	-30 to +110 °C	-20 to +110 °C
MAX. 	2 m/s	2 m/s
	Mining, earth-moving equipment, industrial presses, presses, injection molding machines, support cylinders	



Merkel wiper PU12

External sealing wiper with protruding wiper lip and support segments to prevent twisting, as well as a static sealing edge to the groove base.

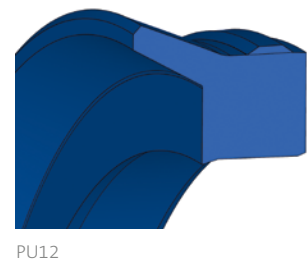

MATERIAL	95 AU V142, 95 AU V149	93 AU V167
MAX. 	-30 to +110 °C	-20 to +110 °C
MAX. 	2 m/s	2 m/s
	Mining, earth-moving equipment, industrial presses, injection molding machines, support cylinders	



WIPERS (DOUBLE-ACTING)

Merkel double wiper P8

Wiper with the functionality of a U-ring internally and outward wiper effect.

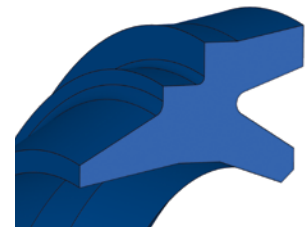

MATERIAL	85 NBR B247	90 NBR B283	90 NBR 109
MAX. 	-30 to +100 °C	-30 to +100 °C	-30 to +110 °C
MAX. 	1 m/s	1 m/s	1 m/s
	Forklift trucks, industrial presses, injection molding machines		



P8

Merkel double wiper P9

Wiper designed specifically for large diameters with the functionality of a U-ring internally and outward wiper effect.

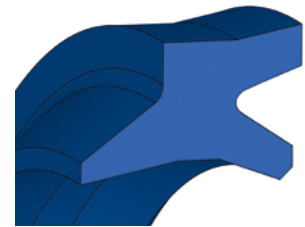

MATERIAL	85 NBR B247
MAX. 	-30 to +100 °C
MAX. 	2 m/s
	Industrial presses, injection molding machines, large standard cylinders



P9

Merkel double wiper PRW1

Wiper with the functionality of a U-ring internally and outward wiper effect. With additionally integrated pressure-relief function. For installation spaces based on ISO 6195 Type A.

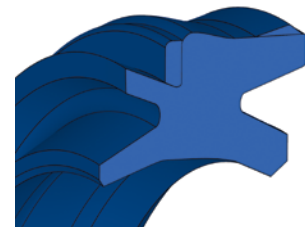

MATERIAL	94 AU 925	92 AU 21100	94 AU 30000
MAX. 	-30 to +110 °C	-50 to +110 °C	-35 to +120 °C
MAX. 	1 m/s	1 m/s	1 m/s
	Earth-moving equipment, forklift trucks, tail lifts, agricultural machines, truck cranes, support cylinders		



PRW1

Merkel double wipers PT1, PT1-DR HB

Wipers, comprising a PTFE profile ring with sealing and wiper edge, as well as two O-rings as pre-load element. Version PT1-DR HB is suitable for combined lifting and turning movements.

MATERIAL	PTFE B602 / NBR; PTFE GM201 / NBR	PTFE B602 / FKM	PTFE GM201 / FKM
 MAX.	-30 to +100 °C	-10 to +200 °C	-10 to +150 °C
 MAX.	5 m/s	5 m/s	5 m/s
	Forklift trucks, large cylinders, handling equipment, agricultural machines, presses, injection molding machines, control devices, rolling mills		

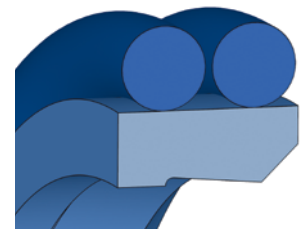

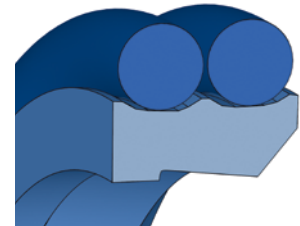

PT1



PT1-DR HB

Merkel double wipers PT2, PT2 PR

Wipers comprising a PTFE profile ring with sealing and wiper edge as well as two O-rings as pre-load element. Version PT2 PR features a pressure-relieved sealing edge.

MATERIAL	PE E084 / NBR	PTFE B602 / NBR; PTFE GM201 / NBR	PTFE B602 / FKM	PTFE GM201 / FKM
 MAX.	-30 to +80 °C	-30 to +100 °C	-10 to +200 °C	-10 to +150 °C
 MAX.	5 m/s	5 m/s	5 m/s	5 m/s
	Industrial presses, injection molding machines, hydraulic steelwork, rolling mills			

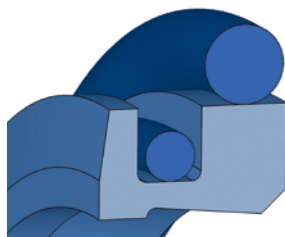

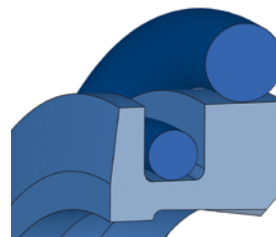

PT2



PT2 PR

Merkel double wiper PT3

External sealing wiper comprising a PTFE profile ring with sealing and wiper edge as well as two O-rings as pre-load element.

MATERIAL	PTFE B602 / NBR; PTFE GM201 / NBR	PTFE B602 / FKM	PTFE GM201 / FKM
 MAX.	-30 to +100 °C	-10 to +200 °C	-10 to +150 °C
 MAX.	5 m/s	5 m/s	5 m/s
	Industrial presses, injection molding machines, hydraulic steelwork, rolling mills		

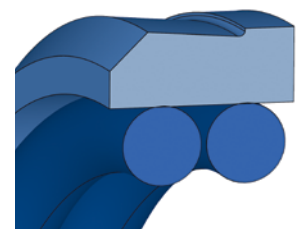

PT3

Merkel double wiper PT4

Wiper, comprising a PTFE profile ring with one sealing edge and one wiper edge as well as an O-ring as pre-load element.

MATERIAL	PTFE B602 / NBR; PTFE GM201 / NBR	PTFE B602 / FKM	PTFE GM201 / FKM
MAX.	-30 to +100 °C	-10 to +200 °C	-10 to +150 °C
MAX.	5 m/s	5 m/s	5 m/s
	Industrial presses, injection molding machines, hydraulic steelwork, rolling mills		

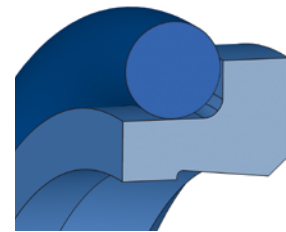

PT4

Merkel double wiper PU1

Wiper, comprising a PU profile ring with one sealing edge and one wiper edge as well as an O-ring as pre-load element.

MATERIAL	95 AU V142; 98 AU V211	93 AU V167
MAX.	-30 to +110 °C	-20 to +110 °C
MAX.	1.5 m/s	1.5 m/s
	Industrial presses, injection molding machines, hydraulic steelwork, rolling mills	

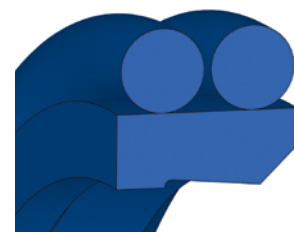

PU1

Double wiper PU11

Wiper with the functionality of a U-ring internally and outward wiper effect. Also suitable for standardized installation spaces as per ISO 6195 Type C.

MATERIAL	95 AU V142	93 AU V167
MAX.	-30 to +110 °C	-20 to +110 °C
MAX.	1 m/s	1 m/s
	Forklift trucks, injection molding machines, standard cylinders	

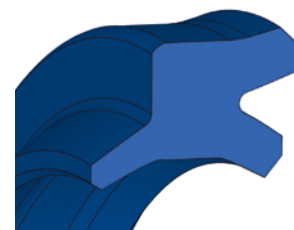

PU11

Double wiper DMRW2

Wiper with the functionality of a U-ring internally and outward wiper effect. With protruding wiper lip, metal housing and additionally integrated pressure-relief function.

MATERIAL	94 AU 30000
MAX.	-35 to +120 °C
MAX.	1 m/s
	Earth-moving equipment, commercial vehicles, tail lifts, agricultural machines, truck cranes, support cylinders, presses

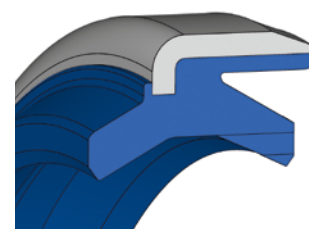

DMRW2